

OWNER'S MANUAL

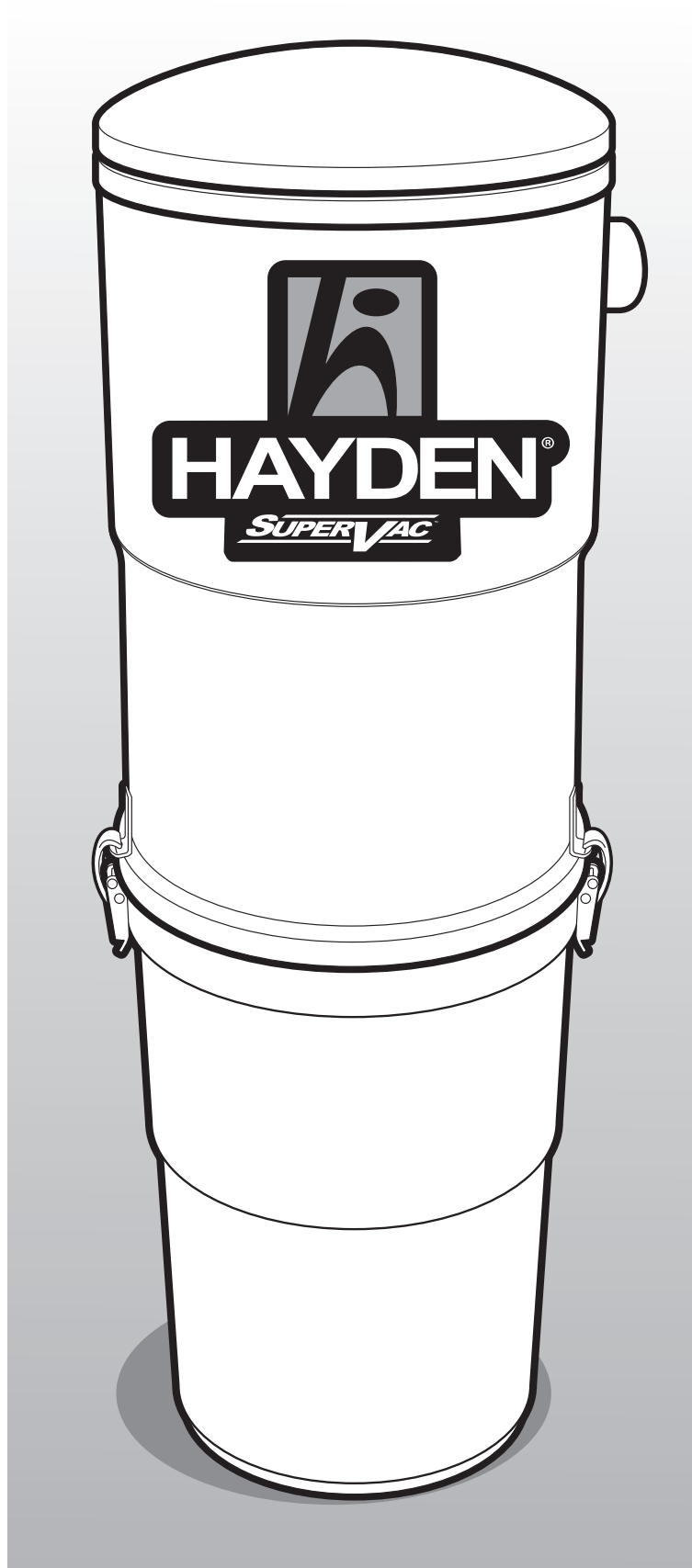

www.canplas.com

Important Safety Instructions

Read All Instructions Before Using

WARNING

To avoid electrical shock, never use hose and tools on a wet surface. To avoid fire hazard, do not use vacuum to pick up matches, fireplace ashes or smoking material.

To reduce the risk of fire, electric shock, injury or damage:

1. **For Residential Use Only:** any use other than residential/household will void warranty.
2. Do not leave vacuum running when not in use.
3. Always unplug from the electrical outlet before servicing the unit.
4. Do not use with damaged cord or plug.
5. Do not allow to be used as a toy. Close attention is necessary when used by or near children.
6. Use only as described in this manual. Use only with recommended attachments and filters.
7. Do not unplug by pulling cord. To unplug, grasp the plug, not the cord.
8. Do not handle plug or vacuum with wet hands - injury may occur.
9. Do not put any object into openings.
10. Do not use when any blockage occurs in the piping system.
11. Keep hair, loose clothing, fingers and all parts of body away from openings and moving parts.
12. Do not pick up anything that is burning or smoking such as: cigarettes, matches or hot ashes.
13. Do not use without filter in place. If the unit is a cartridge filter version, do not use without separator cone, filter retainer and cartridge filter securely in place.
14. Turn off all controls before unplugging.
15. Use extra care when cleaning on stairs.
16. Do not use to pick up flammable or combustible liquids such as gasoline or any other liquids, or use in areas where they may be present. This could cause serious damage to the power unit and may eventually result in a plugged system due to dirt build-up inside the piping system.
17. Avoid nails or wood splinters as they could plug or damage the system.
18. Do not store items on top of the power unit as this will restrict the cooling airflow, which may cause the motor to overheat.
19. Connect to properly grounded outlet only. See grounding instructions. Failure to do so could result in injury or damage to the machine.
20. Do not vacuum drywall dust or construction debris. This will void the warranty.

Grounding Instructions

A. For all grounded, cord-connected appliances:

This appliance must be grounded. If it should malfunction or break down, grounding provides a path of least resistance for electric current to reduce the risk of electric shock. This appliance is equipped with a cord having an equipment-grounding conductor (A) and grounding plug (B). This plug must be inserted into an appropriate outlet (C) that is properly installed and grounded in accordance with all local codes and ordinances.

Warning – Improper connection of the equipment – grounding conductor can result in a risk of electric shock. Check with a qualified electrician or service person if you are in doubt as to whether the outlet is properly grounded. Do not modify the plug provided with the appliance – if it will not fit the outlet, have a proper outlet installed by a qualified electrician.

B. For a grounded, cord-connected appliance rated less than 15 amperes and intended for use on a nominal 110/120 – volt supply circuit:

This appliance is for use on a nominal 110/120-volt circuit, and has a grounded plug that looks like the plug illustrated in Figure 1 – 1.

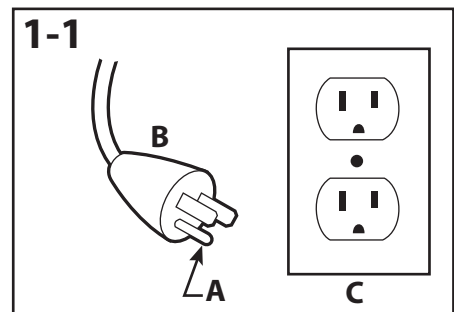

Note: For 220 Volt and other installations please refer to local Electrical Codes or a Certified Installer.

Contents Contained And Packaged With Your Power Unit:

SuperVac Classic / 5000 Models

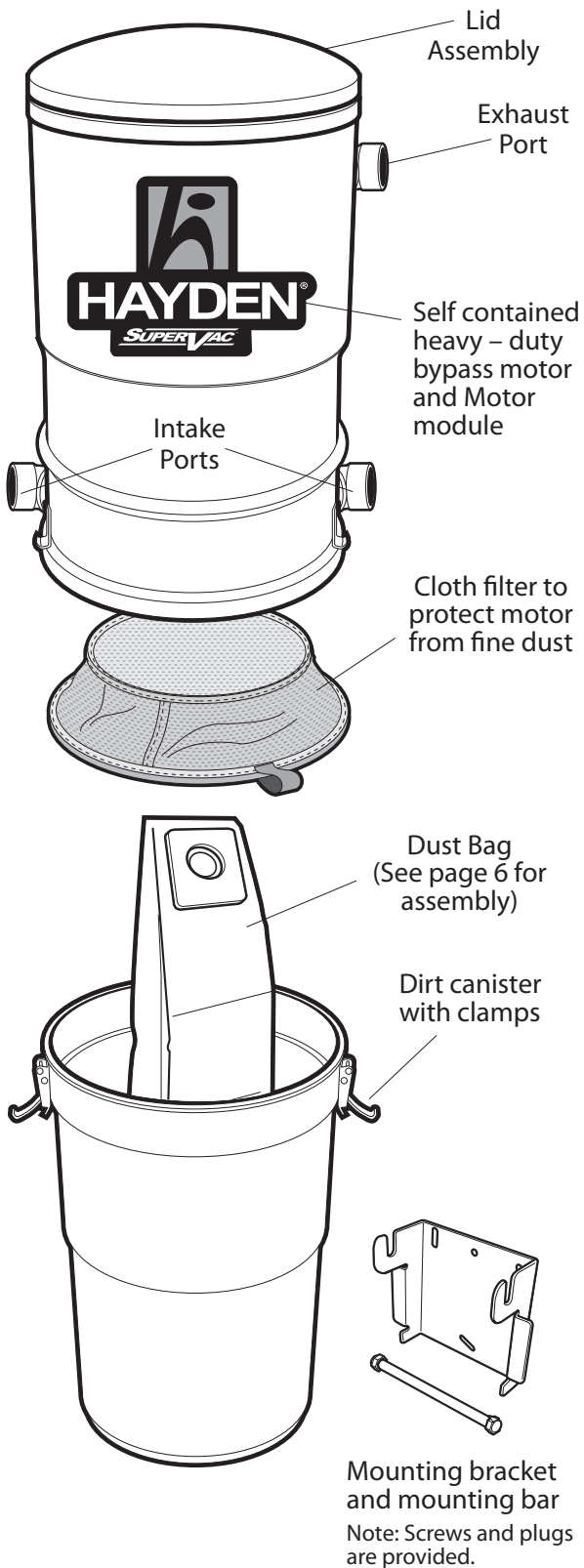

SuperVac 9000 / 7000 Models

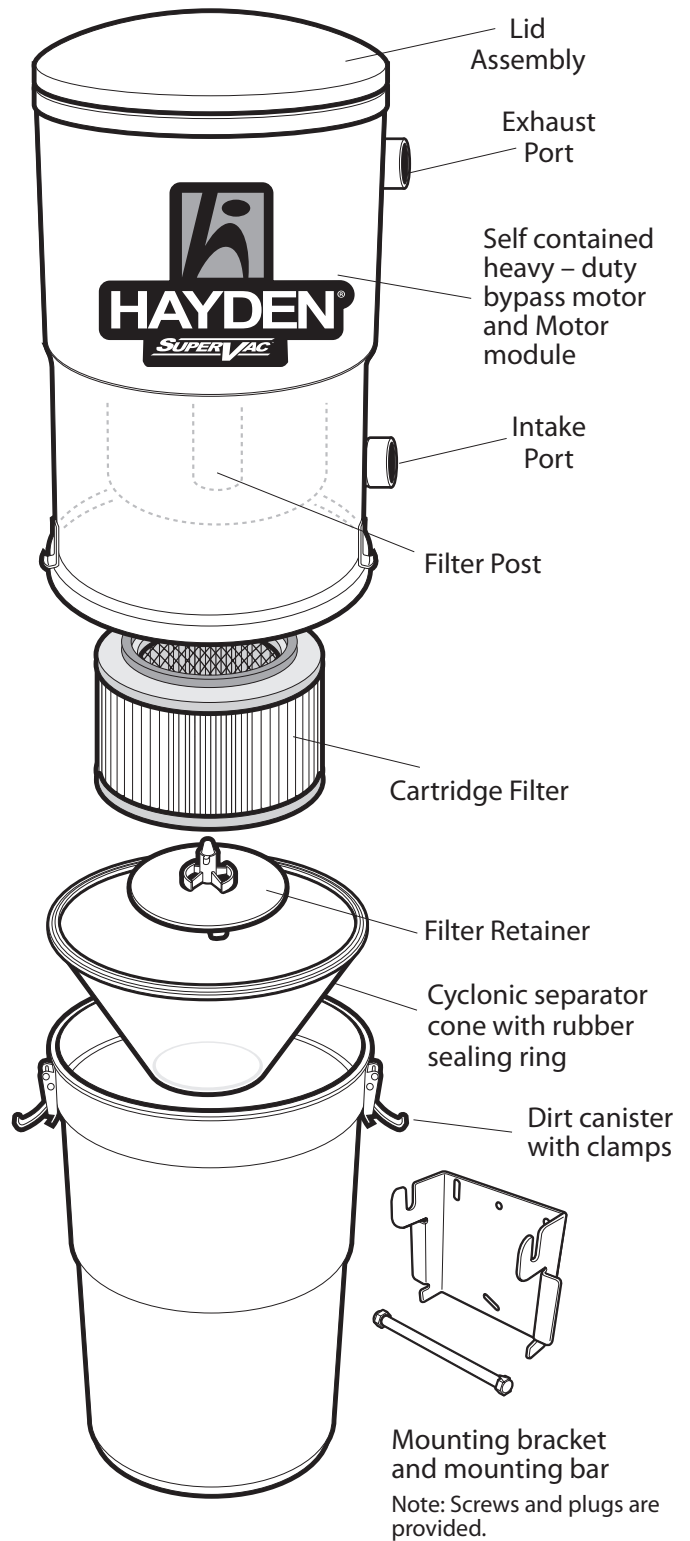

Installation

Location For The Power Unit

The SuperVac power unit is usually located in the garage or utility room where motor noise will cause minimum disturbance.

The power unit requires ventilation. DO NOT install in a heat producing or confined area such as the attic, furnace room, etc. It is highly recommended that the power unit be exhausted to the outside.

The top of the unit should be no less than 12" (30.5 cm) from the ceiling and any corner wall to allow proper cooling to the motor. For ease of removing the dirt canister, the bottom of the unit should be at least 18" (46 cm) above the floor.

Central Vacuum power units require a separate / dedicated, 110/120 Volt, 60 Hz., 20 Amp, 3-wire grounded power circuit, protected by a 110/120 Volt, 60 Hz., AC, 20 Amp time-delay fuse or circuit breaker and a 110/120 Volt, 60 Hz., 20 Amp grounded receptacle. If a 110/120 Volt, 60 Hz., 20 Amp grounded receptacle is not available, have a qualified electrician install one for you. The receptacle should be no more than 5 feet (152 cm) from the Power Unit. For 220 installations refer to local electrical codes.

Under no circumstance should an extension cord be used with this power unit.

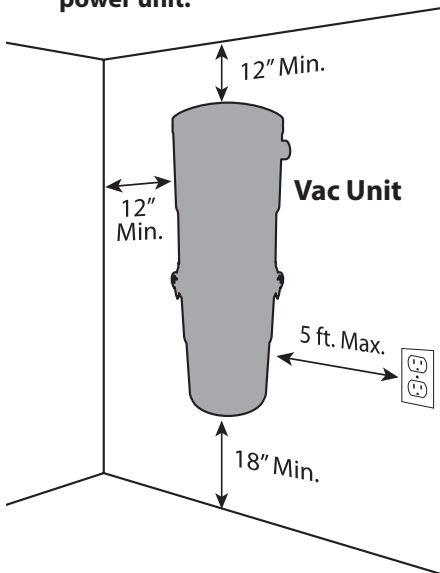

Mounting Bracket

Fig. 2-1

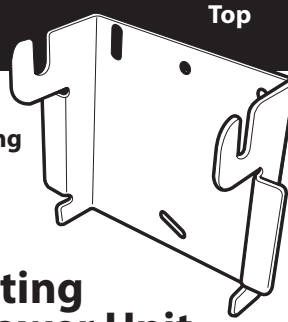

Mounting The Power Unit

1. Determine if the wall on which the power unit will be mounted is block, concrete, or plaster / drywall.

2. Block or Concrete Wall

You will need (2) 1-1/2" (3.8 cm) x 1/4" (0.64 cm) lead plugs and (2) 1-1/2" (3.8 cm) x 1/4" (0.64 cm) lag bolts. Drill a 1/2" (1.3 cm) dia. x 1-3/4" (4.4 cm) deep hole with a masonry drill bit. Insert a lead plug into the hole.

Mount the bracket (Fig 2-1) from a top hole with a lag bolt. Mark the other upper hole of the bracket. Make sure that the bracket is straight. Slide the bracket away from the mark and drill a hole directly over the mark.

Insert a lead plug into the hole. Align the bracket over the hole and tightly fasten with a lag bolt. Continue to 4.

3. Drywall or Plaster Wall

You will need (2) 1-1/2" (3.8 cm) x 1/4" (0.64 cm) wood screws. Locate a stud and drill a 1/8" (0.32 cm) dia. x 1-3/4" (4.4 cm) pilot hole. Mount the bracket from a top hole with a wood screw. Make sure that the

bracket is straight. Drill a second pilot hole using a lower hole on the bracket and fasten tightly with the other wood screw.

4. Mount the Power Unit on the bracket making sure the bar on the back of the machine is settled to the bottom of the slots on the mounting bracket. The wall mounting bracket must fit between the two brackets on the back of the power unit.

5. Route the intake tubing to the power unit and insert into the intake port on the unit. **Do NOT cement pipe to the plastic intake port.**

6. A noise-reducing muffler (A) may be included in the pack, which can be installed as shown in Fig. 2-2. Connect the muffler to the exhaust port on the unit. **Do not cement to the plastic exhaust port.**

7. Connect the 24 Volt wires coming from the wall valves into the 24 Volt receptacle on the unit.

8. Plug the power cord (110/120/220 Volt) into the electrical outlet on the wall.

9. Assuming that the wall inlet valves are connected properly, the vacuum system is now ready.

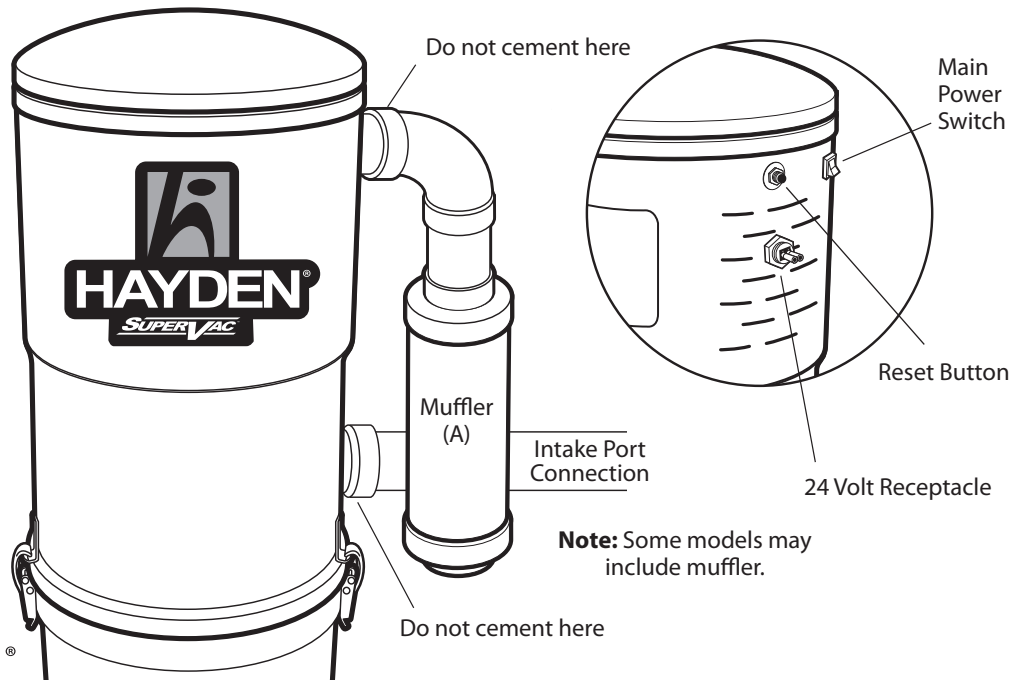

Fig. 2-2

Remove The Waste And Clean The Filter

1. Unplug the power unit prior to emptying the dirt canister or cleaning the filter.

2. Remove The Waste:
Remove the dirt canister by simply undoing the two clamps located on each side of the canister and gently pulling the canister in a downward direction.

Empty contents of the dirt canister into a garbage container.

Re-install the dirt canister and ensure proper seal.

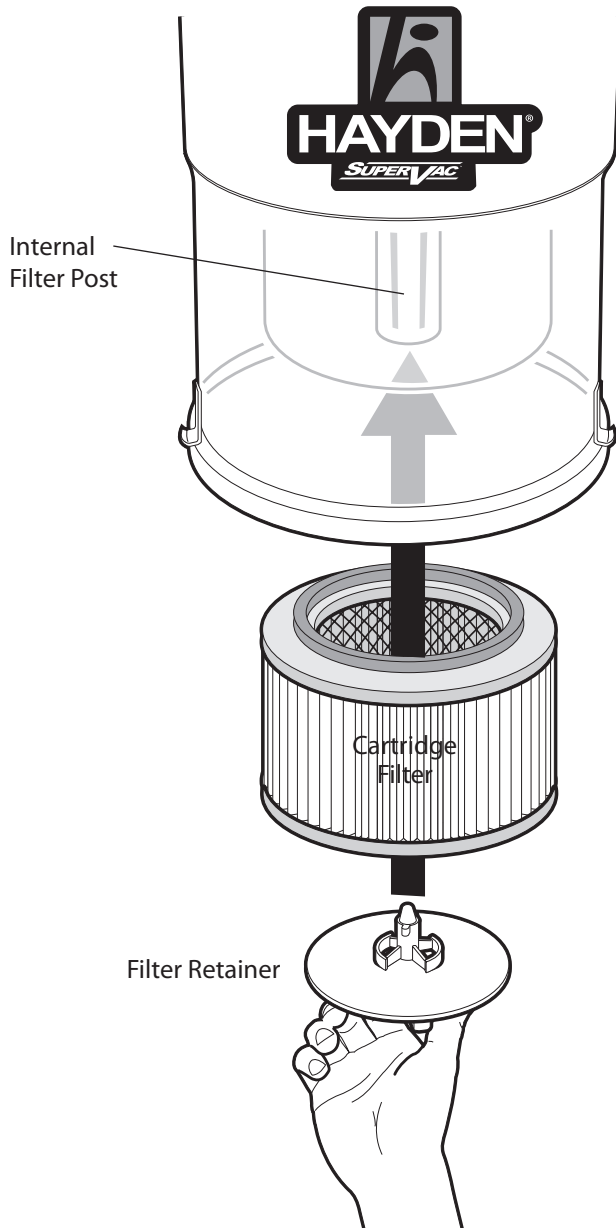
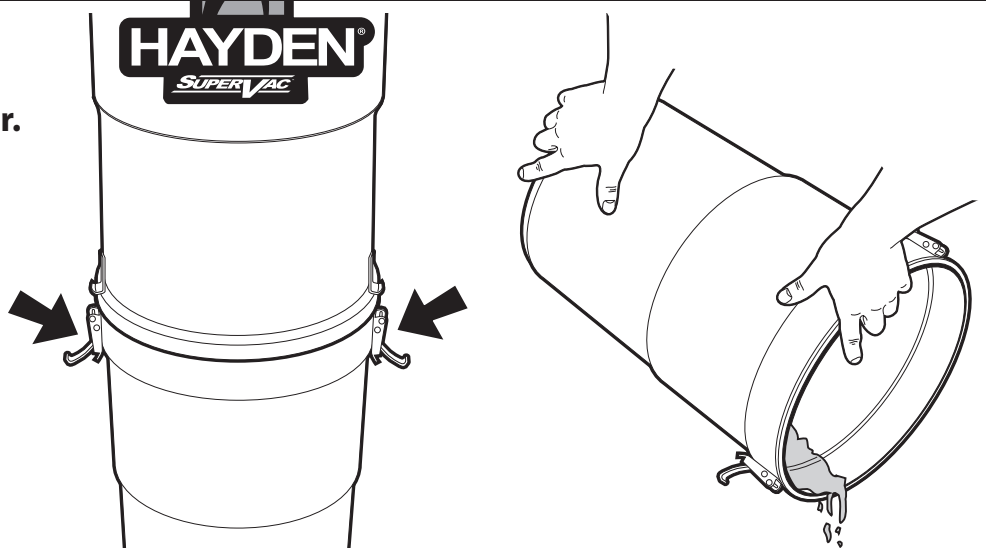

3. Cleaning The Filter:

The filter systems of Hayden central vacuum power units are different.

Part #	Model	Filter System
81SV90	SuperVac 9000	Washable Cartridge Filter
81SV70	SuperVac 7000	Washable Cartridge Filter
81SV90CLA	SuperVac Classic	Bag w/ Self-Cleaning Cloth Filter
81SV50	SuperVac 5000	Bag w/ Self-Cleaning Cloth Filter

See Step 3.1 For Cleaning The Cartridge Filter.

See Step 3.2 For Cleaning The Self-Cleaning Filter.

3.1 Cleaning The Washable Cartridge Filter:

Models: SuperVac 9000 / 7000

Remove the filter by pushing up the filter retainer, turning it slowly counter-clockwise and then pulling down. Grasp the filter and remove.

First, shake off larger debris into a garbage container and then rinse it off under clean running water. **Wait until it dries and then re-install into the unit.**

It is recommended to have two filters at home: if one filter has just been cleaned and is still drying, install the other clean and dry filter so that the vacuum can continue to be used.



3.2. Changing Bags and Cleaning the Self-Cleaning Filter:

Models: SuperVac Classic / 5000

Removing and Assembling Dust Bag

When assembling dust bag, hold the bag locking ring and slide over the locking tabs on the intake port as shown. Ensure the bag is secured behind tabs.

To remove the bag, hold the bag locking ring and carefully lift off of tabs until bag is free.

Note: Bags are not re-usable

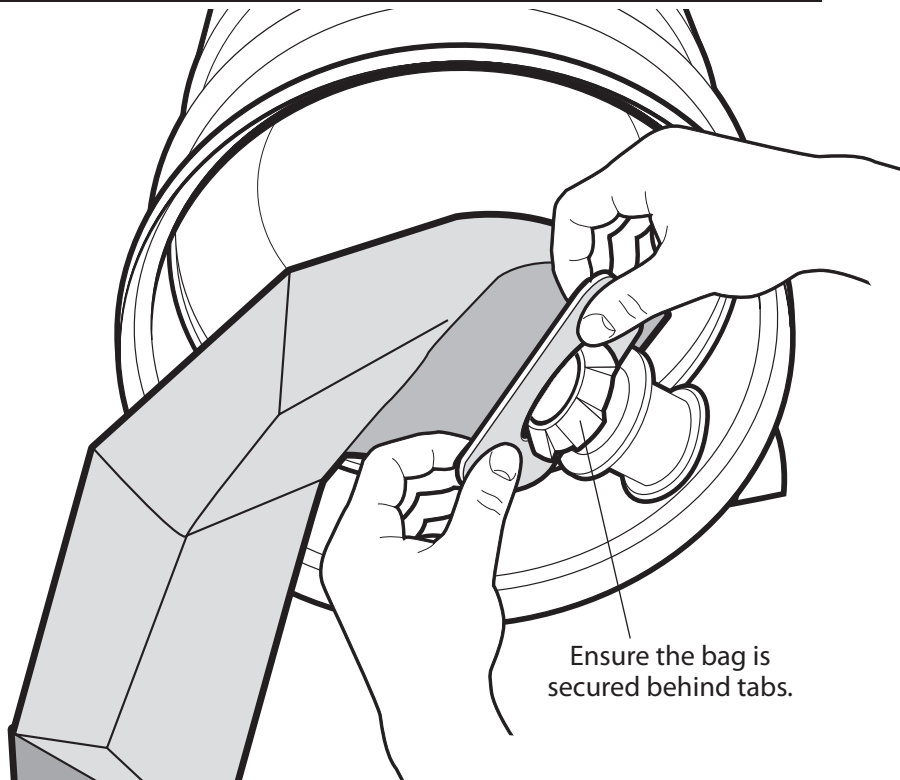

Cleaning Filter:

Place a plastic bag over the cloth filter and around the cyclonic deflector that surrounds the filter.

Using the plastic bag as hand protection from dirt particles, shake the filter to cause any particles adhering to the filter to fall into the bag (Fig 4-1).

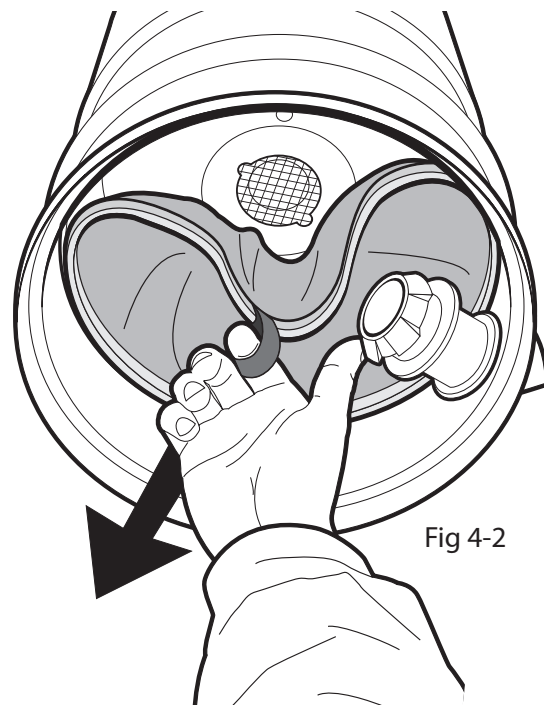

Removing Self-Cleaning Cloth Filter:

If the cloth filter should need to be removed, grasp the pull tab on the side of the filter near the top and pull towards the center of the filter to create a "V" or "U" shape (see Fig. 4-2). Then remove it from the unit.

Re-Installing Self-Cleaning Cloth Filter:

Create "V" or "U" Shape.

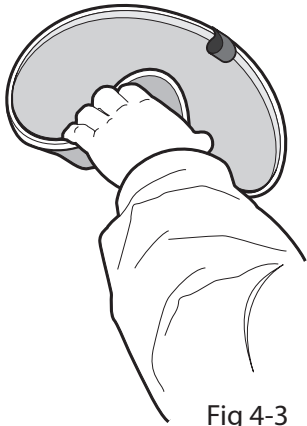
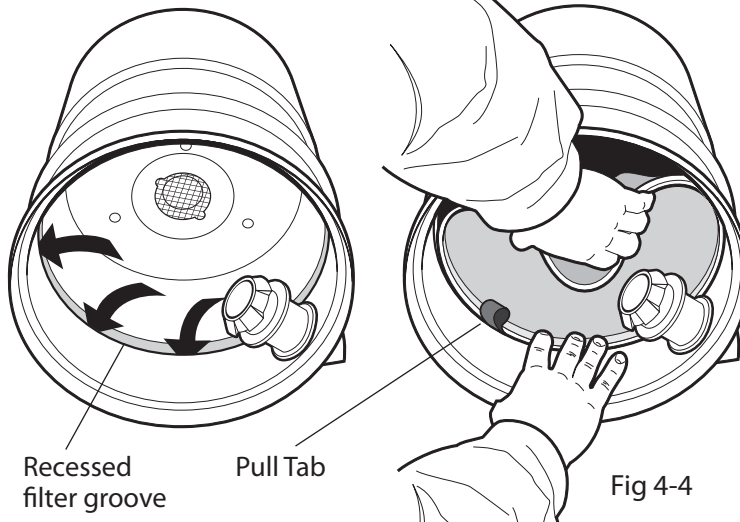

Fig 4-3

To re-install, decrease the circumference of the filter by gently grasping one side of the filter ring and squeezing together to create a "V" or "U" shape, Fig 4-3



Recessed filter groove

Pull Tab

Fig 4-4

Place the filter back into the groove as shown and let the filter snap outward into the remaining groove. **NOTE:** Printing must be on the inside of the cloth filter when re-installed. Ensure pull tab is accessible while re-installing, which will be used to remove the filter for future maintenance.

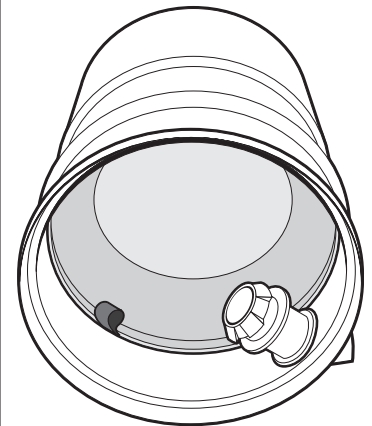

Fig 4-5

WARNING

IMPORTANT: Make sure that the cloth filter fits properly into the groove, so it will not come out when the machine is turned on. Failure to do so may damage the motor and void the warranty of the unit.

4. Miscellaneous

Debris from the dirt canister should be emptied before the dust level reaches to within 4" (10cm) of the separator cone (SV9000 and SV7000 model). Do not overfill the dirt canister. **To ensure optimal operation of your power unit, it should be emptied and cleaned on a regular basis.**

Do not run the vacuum power unit without a filter. The warranty will be void for motor damages resulting from vacuuming without a filter or vacuuming with an improper filter installation.

Do not use your power unit to vacuum drywall dust, construction debris, tree needles or any material from commercial or industrial sources. This unit is only intended for residential use. Damage resulting from unintended use may invalidate the warranty.

Trouble Shooting Guide

Read Before Calling For Service

Problem	Possible Solutions
Power unit fails to operate	<ol style="list-style-type: none"> 1. Check if power cord is plugged firmly into the electrical wall outlet. 2. Test the electrical outlet with another working appliance. 3. Depress reset button on the power unit. 4. Check low voltage wiring connections throughout the pipe system. 5. Check inlet valve if the contact points are operative.
Power unit fails to turn off	<ol style="list-style-type: none"> 1. Check for short circuiting of the low voltage wire along the piping. (e.g. on heating ducts or hot water pipe) 2. Check if a hose is plugged into another inlet valve.
Loss or decrease in suction	<ol style="list-style-type: none"> 1. Empty dirt canister and clean filter. 2. Check if the dirt canister, separator cone and gasket are sealed and clamped into place properly. 3. Check all inlet valves for correct sealing. 4. Check hose for blockage. Do not use any sharp objects to do this. 5. Check pipe or hose connection for a possible rupture. 6. Check for and locate blockage in the piping system. First, verify vacuum suction in the unit itself by removing the intake pipe. Then check at each inlet valve. Lines may be purged by inserting the hose into each inlet valve and quickly covering and uncovering the open hose end with the palm of your hand.
<p>Note: If none of these trouble-shooting suggestions restore proper performance, please contact the dealer from whom the unit was purchased for service suggestions or for further inspection.</p>	

Registration Card

Customer Copy

Please complete and keep with manual
for future reference



Warranty Registration Card

Go to www.canplas.com and register on-line
or

Please complete and mail to validate
warranty. Address on the reverse side.

Select Product

- SuperVac™ 9000
- SuperVac™ 7000
- SuperVac™ Classic
- SuperVac™ 5000
- Other: _____

Name

Email Address

() ()

Telephone Number Fax Number

Address

City Province or State

Postal or Zip Code Date of Purchase

Country

Dealer

()

Dealer Telephone Number

Dealer / Installer Information

Company Name

Phone Number

Model Number Serial Number

Date of Installation

Select Product

- SuperVac™ 9000
- SuperVac™ 7000
- SuperVac™ Classic
- SuperVac™ 5000
- Other: _____

Name

Email Address

() ()

Telephone Number Fax Number

Address

City Province or State

Postal or Zip Code Date of Purchase

Country

Dealer

()

Dealer Telephone Number

Dealer / Installer Information

Company Name

Phone Number

Model Number Serial Number

Date of Installation



Canplas Industries LTD.
500 Veterans Drive, Box 1800
Barrie, Ontario, L4M 4V3
Canada

**This original must be completed and
mailed within 14 days of purchase to
validate warranty.**

Manufacturers Warranty



To the original purchaser of any Hayden branded products that are manufactured by Canplas Industries Ltd. and listed on this warranty card, Canplas Industries Ltd. warrants against defects in material and workmanship under normal use and service and for the following periods:

- All SuperPack Kits** (hose & power nozzle only).....One (1) year
- SuperVac 5000 Power Unit** (motor and internal electrical components only).....Five (5) years
- SuperVac 7000 Power Unit** (motor and internal electrical components only).....Seven (7) years
- SuperVac 9000 Power Unit** (motor and internal electrical components only).....Ten (10) years *(Limited)
- SuperVac Classic Power Unit** (motor and internal electrical components only)Ten (10) years *(Limited)

*(Limited): For the first 7 years, Canplas Industries Ltd. will be 100% responsible for the warranty, including parts and labour cost (excluding all transportation charges and/or charges associated with the removal from premises and charges related to packaging). For the following 3 years, Canplas Industries Ltd. will be responsible for 50% of the parts and labour cost (excluding all transportation charges and/or charges associated with the removal from premises and charges related to packaging), and the owner is responsible for the other 50% of the parts and labour cost.

Note: Filters & Motor Brushes of power units, and vacuum tools in the kits are considered normal wear and tear items and are not covered under warranty.

Please fill out the attached OWNER'S REGISTRATION CARD completely and mail to Canplas Industries Ltd. as soon as possible, as this warranty shall only become effective if the completed card is received within fourteen days of the date of purchase from an Authorized Hayden Dealer. This warranty registration can also be completed online at www.canplas.com.

Canplas Industries Ltd. agrees to repair or replace any parts that are proved to be defective at the manufacturer's sole discretion upon their return to the nearest Authorized Hayden Service Center without charge. Canplas Industries Ltd. is not responsible for any transportation charges and/or charges associated with the removal from premises and charges related to packaging.

If there is no Authorized Hayden Service Centre in the area where the owner is living, or the owner believes that the Centre is too far away and does not want to bring the product to the Centre for service, the owner should send the product at the owner's expense to Canplas Industries Ltd. at the address of 31 Patterson Road, Barrie, Ontario, L4M 4V3, Canada, for repair or replace. Canplas Industries Ltd. will be responsible for sending the repaired or replaced product back to the owner.

All Hayden branded central vacuum products are for residential use. This warranty shall not apply if such products are used for any purposes other than its intended use, including any construction (including drywall dust and construction debris), commercial or industrial applications.

This warranty shall not apply if normal prescribed maintenance has not been followed or if the products have been abused, misused, willfully damaged, damaged by fire, flood, or any act of God.

This warranty does not apply to vacuum tubing, fittings, inlet valves, and any parts associated with the installation process, nor any defects caused by improper installation.

Canplas Industries Ltd. does not authorize any person, including any dealer, agent, or representative to make any other warranties or conditions, expressed or implied, except those herein contained. Canplas Industries Ltd. shall not be responsible for, or subject to, any action for damages or loss resulted from any failure or imperfection of the products.

All products manufactured and sold by Canplas Industries Ltd. are carefully inspected for manufacturing defects. However, it is not always possible to detect hidden defects. Said products are warranted only to the extent that Seller will repair or replace, at seller's discretion and without charge, products proven to have manufacturing defects within the warranty period beginning the date of purchase thereof and provided Seller has been given an opportunity to inspect the product alleged to be defective and the installation or use thereof.

NO WARRANTY IS INCLUDED AGAINST ANY EXPENSE FOR REMOVAL, REINSTALLATION OR OTHER CONSEQUENTIAL DAMAGES ARISING FROM ANY DEFECTS. THE WARRANTIES SET OUT ABOVE ARE THE ONLY WARRANTIES MADE BY SELLER AND ARE EXPRESSLY IN LIEU OF ALL OTHER WARRANTIES, EXPRESSED OR IMPLIED, INCLUDING THE WARRANTIES OF MERCHANTABILITY AND FITNESS FOR A PARTICULAR PURPOSE.



Canplas Industries Ltd.
500 Veterans Drive, Box 1800
Barrie, Ontario, L4M 4V3
Canada
Toll Free: 1-800-501-5018
www.canplas.com